

KINGS COURT - CAR PARK

| Park Space | Flat No. | | | Park Space | Flat No | |
|-------------------|-----------------|-------------------|--|-------------------|----------------|-------------------|
| 1 | 2 | 25 Cox Street | | 38 | 9 | 25 Cox Street |
| 2 | 1 | 25 Cox Street | | 39 | 8 | 25 Cox Street |
| 3 | 22 | 25 Cox Street | | 40 | 7 | 25 Cox Street |
| 4 | 21 | 25 Cox Street | | 41 | 6 | 25 Cox Street |
| 5 | 20 | 25 Cox Street | | 42 | 5 | 25 Cox Street |
| 6 | 19 | 25 Cox Street | | 43 | 4 | 25 Cox Street |
| 7 | 18 | 25 Cox Street | | 44 | 3 | 25 Cox Street |
| 8 | 17 | 25 Cox Street | | 45 | 24 | 25 Cox Street |
| 9 | 14 | 108 Livery Street | | 46 | 23 | 25 Cox Street |
| 10 | 12 | 108 Livery Street | | 47 | 38 | 25 Cox Street |
| 11 | 11 | 108 Livery Street | | 48 | 39 | 25 Cox Street |
| 12 | 10 | 108 Livery Street | | 49 | 40 | 25 Cox Street |
| 13 | 9 | 108 Livery Street | | 50 | 25 | 108 Livery Street |
| 14 | 8 | 108 Livery Street | | 51 | 26 | 108 Livery Street |
| 15 | 7 | 108 Livery Street | | 52 | 27 | 108 Livery Street |
| 16 | 6 | 108 Livery Street | | 53 | 28 | 108 Livery Street |
| 17 | 5 | 108 Livery street | | 54 | 29 | 108 Livery Street |
| 18 | 4 | 108 Livery Street | | 55 | 46 | 25 Cox Street |
| 19 | 3 | 108 Livery Street | | 56 | 45 | 25 Cox Street |
| 20 | 2 | 108 Livery Street | | 57 | 44 | 25 Cox Street |
| 21 | 1 | 108 Livery Street | | 58 | 43 | 25 Cox Street |
| 22 | 24 | 108 Livery Street | | 59 | 42 | 25 Cox Street |
| 23 | 23 | 108 Livery Street | | 60 | 41 | 25 Cox Street |
| 24 | 22 | 108 Livery Street | | 61 | 37 | 25 Cox Street |
| 25 | 21 | 108 Livery Street | | 62 | 36 | 25 Cox Street |
| 26 | 20 | 108 Livery Street | | 63 | 35 | 25 Cox Street |
| 27 | 19 | 108 Livery Street | | 64 | 34 | 25 Cox Street |
| 28 | 18 | 108 Livery Street | | 65 | 33 | 25 Cox Street |
| 29 | 17 | 108 Livery Street | | 66 | 32 | 25 Cox Street |
| 30 | 16 | 108 Livery Street | | 67 | 31 | 25 Cox Street |
| 31 | 15 | 108 Livery Street | | 68 | 30 | 25 Cox Street |
| 32 | 16 | 25 Cox Street | | 69 | 29 | 25 Cox Street |
| 33 | 15 | 25 Cox Street | | 70 | 28 | 25 Cox Street |
| 34 | 14 | 25 Cox Street | | 71 | 27 | 25 Cox Street |
| 35 | 12 | | | 72 | 26 | 25 Cox Street |
| 36 | 11 | 25 Cox Street | | 73 | 25 | 25 Cox Street |
| 37 | 10 | 25 Cox Street | | 74 | 12 | 25 Cox Street |

1:200 at A3 0 5 10 15 20 METRES

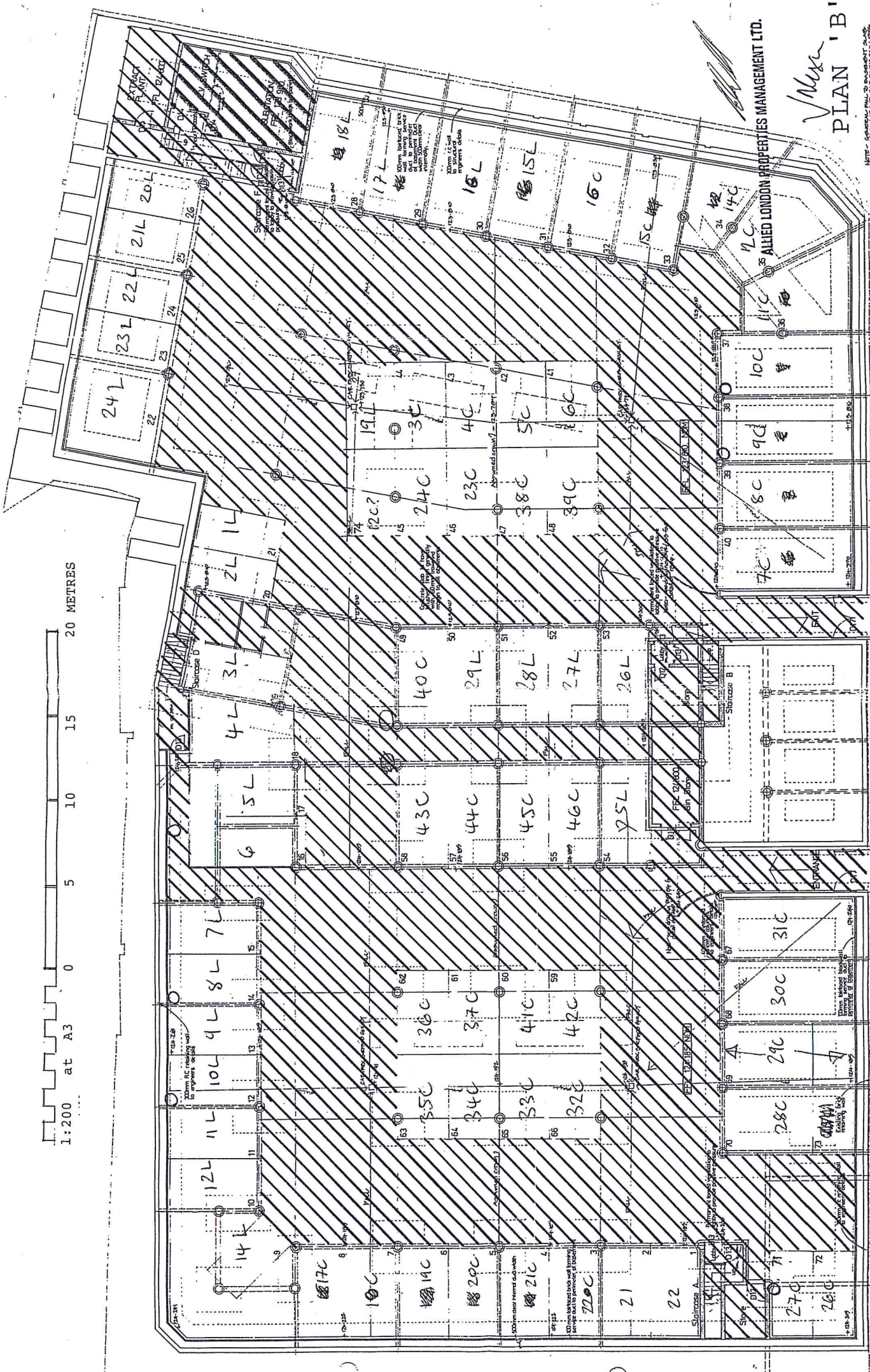

ALLIED LONDON PROPERTIES MANAGEMENT LTD.
V. N. S.
 PLAN 'B'

NOTE: ALL DIMENSIONS TO FACE UNLESS OTHERWISE STATED.
 DIMENSIONS TO FACE UNLESS OTHERWISE STATED.
 DIMENSIONS TO FACE UNLESS OTHERWISE STATED.

ASSOCIATED ENGINEERS

1:200 at A3 JUNE 88

REVISION A

BASEMENT PLAN

REDUCED COPY PROVIDED FROM ORIGINAL SCALE OF 1:100